

Specifications

Default Values	Input Voltages	Tally Rating	Power Consumption	Video Input Specifications	Video Output Specifications
NK-IPS192.168.20.100	Panel100 - 120V~220 - 240V~47-63Hz	Input Voltage: 24VAC (rms) / 40VDCMaximum Current: 120mAImpedance: < 15 ohms	Carbonite 1024W 2.0A 12VCarbonite 1-A30W 2.5A 12VCarbonite 1M30W 2.5A 12VCarbonite 242W 3.5A 12VCarbonite 2M50W 4.2A 12VCarbonite 2S54W 4.5A 12VCarbonite 2X66W 5.5A 12VCarbonite 3S66W 5.5A 12VCarbonite 3X84W 7.0A 12VCarbonite 3X eXtreme500W 34A 14.6V	Equalization>100m @ 1.5 Gb/s (using Belden 1694 cable)>300m @ 270 Mb/s (5°-40°C)Impedance75 ohm, terminatingVideo InputsSMPTE 259M/292M serial digital (non-looping)Reference InputsStandard Definition — analog black (non-terminating, looping)High Definition — tri-level sync	Return Loss< -23dB @ 1.5GHz< -18dB @ 3GHzRise and Fall Time800ps +/- 10% (SD)240ps +/- 10% (HD)Signal Level800mV +/- 10%DC Offset0 VoltsOvershoot< 10%HD Mode10-bit SMPTE-292M serial digital
Frame IP (LAN1)192.168.0.123Frame IP (LAN2)0.0.0.0FTP User nameuserFTP Passwordpassword	Frame100 - 240V~50-60Hz6.25 - 3.15A	TemperatureOperating: 0 - 40°C (32 - 104°F)Storage: -20 - 85°C (-4 - 185°F)			

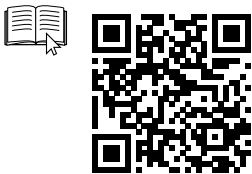

Power and Cabling

**Note:** Refer to the documentation that came with the Ross Routing Systems NK-IPS for setup information.

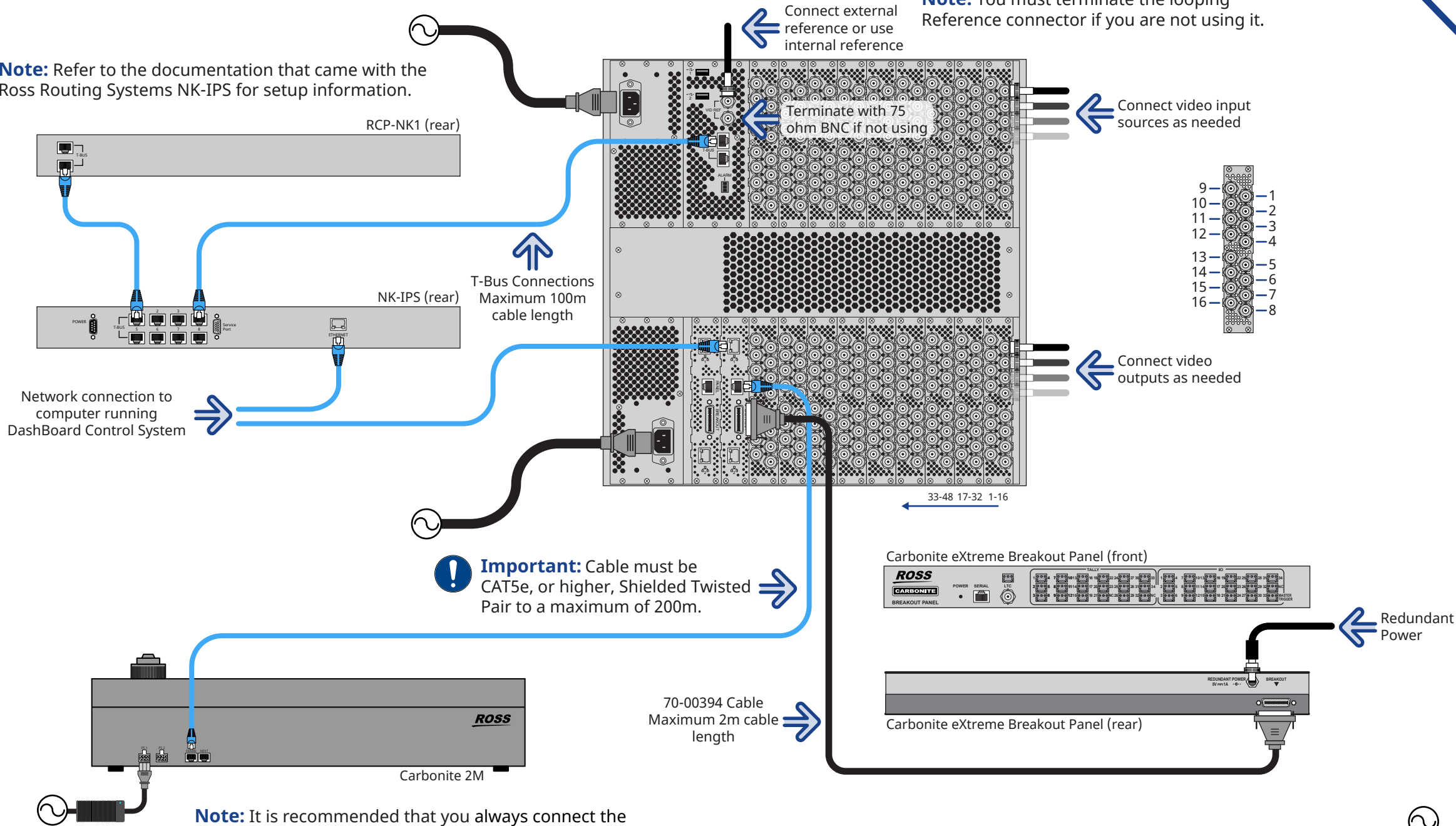

Frame Door Opening

**Important:** Only qualified service personnel are allowed to replace or service system boards and/or cards.

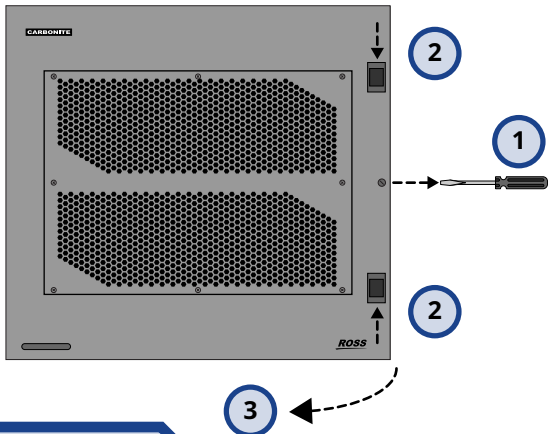

Frame Dust Filter

Remove frame door before cleaning the dust filter.

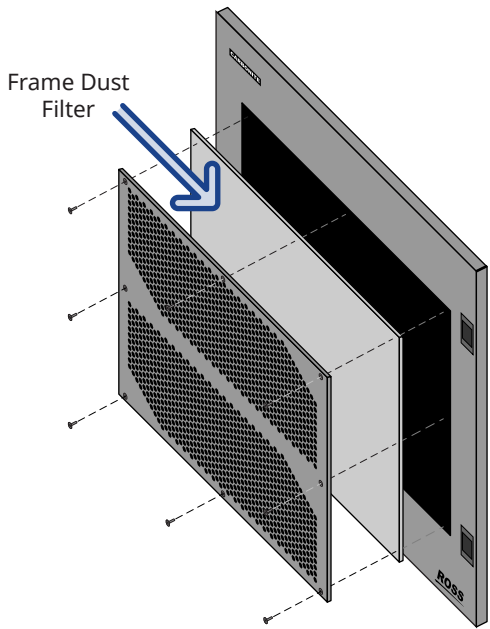

**Note:** The Dust Filter located inside the frame door should be kept clean and free of dust buildup to ensure proper cooling of the frame. Always ensure that the Dust Filter is covering all the holes in the door.

Having a problem? Call our free, 24-hour technical support hotline to speak with a live product specialist located right here in our facility.  
Tel: (+1) 613 • 652 • 4886  
Email: techsupport@rossvideo.com