

### PIVOTCam-20 Video Outputs/Control

#### Nport® 5150A Default Ethernet Settings

IP Address — 192.168.127.254  
Port — 4001

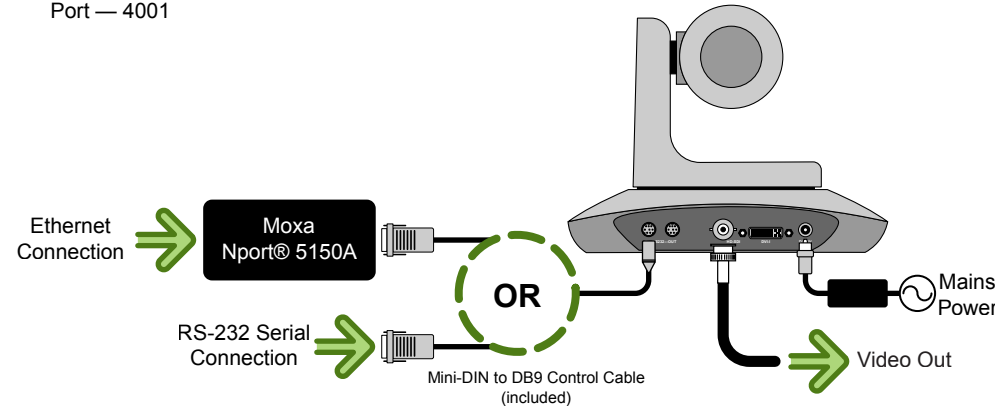

#### PIVOT RS232 (female DIN)

| Pin | Signal |
|-----|--------|
| 1   | DTR    |
| 2   | DSR    |
| 3   | TXD    |
| 4   | GND    |
| 5   | RXD    |
| 6   | A(+)   |
| 7   | IR OUT |
| 8   | B(-)   |

#### Nport Port 1 (female DB9)

| Pin | Signal |
|-----|--------|
| 1   | DCD    |
| 2   | RXD    |
| 3   | TXD    |
| 4   | DTR    |
| 5   | GND    |
| 6   | DSR    |
| 7   | RTS    |
| 8   | CTS    |

### PIVOTCam-20 Daisy Chaining

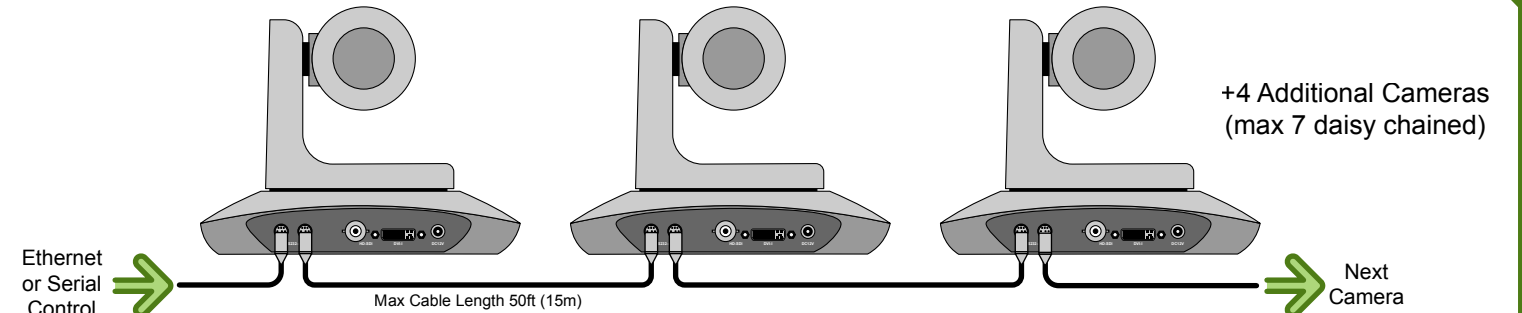

**Note:** When used in a daisy chain, each camera must be set to a different Address (1-7) from the System menu.

### PIVOTCam-SE Video Input/Outputs/Reference/Control

**Note:** The PIVOTCam-SE accepts PoE (Power over Ethernet) and can be powered either by the ethernet connection or the mains power connection. Both can be connected at the same time.

#### PIVOTCam-SE Default Ethernet Settings

IP Address — 192.168.1.188  
Port — 52381

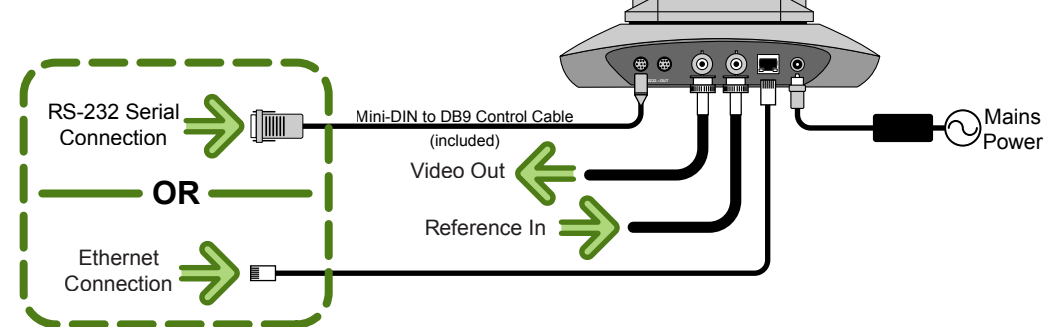

#### PIVOT RS232 (female DIN)

| Pin | Signal |
|-----|--------|
| 1   | DTR    |
| 2   | DSR    |
| 3   | TXD    |
| 4   | GND    |
| 5   | RXD    |
| 6   | A(+)   |
| 7   | IR OUT |
| 8   | B(-)   |

**Note:** It is recommended that you always connect the AC Power Adapter to the device before connecting to Mains Power.



### PIVOTCam-SE Daisy Chaining

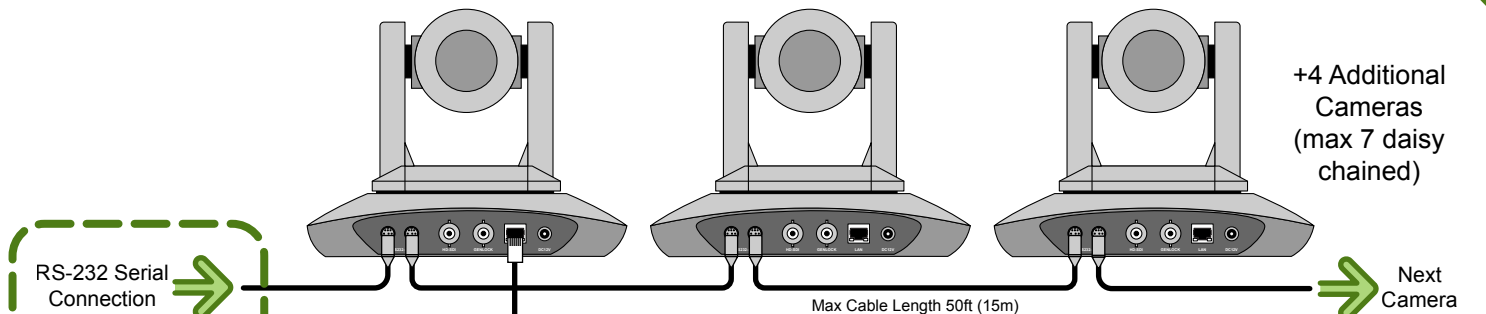

**Note:** When used in a daisy chain, each camera must be set to a different Address (1-7) from the System menu.

### Moxa Nport® 5150A Setup (PIVOTCam-20 Only)

Refer to the documentation that came with your Nport® 5150A for safety and setup information.

Use the NPort Administrator or web interface to set up the Nport® 5150A as follows:  
(The default password is **moxa**)

#### Operation Mode

Operation Mode — TCP Server Mode  
Max Connection — 2 (or more)

#### Serial Parameters

Baudrate — 9600  
Data bits — 8  
Stop bits — 1  
Parity — None  
Flow control — RTS/CTS  
FIFO — Enable  
Interface — RS-232

#### Ethernet Parameters

IP Address — default IP is shown on the bottom of the device  
Local TCP Port — 4001 (default)

### PIVOTCam-20 Setup

Set up the PIVOTCam-20 to communicate with the Moxa Nport® 5150A as follows:

#### SYSTEM

RS485 — set to OFF  
BAUD RATE — set to 9600

### PIVOTCam-SE Setup

Set up the PIVOTCam-SE as follows:

#### SYSTEM (Serial Communication)

RS485 — set to OFF  
BAUD RATE — set to 9600  
VISCA — OVER COM

#### SYSTEM (Ethernet Communication)

VISCA — OVER IP



Having a problem? Call our free, 24-hour technical support hotline to speak with a live product specialist located right here in our facility.

**Tel (North America):** 1-844-652-0645

**Tel (International):** +800 1005 0100

**Email:** techsupport@rossvideo.com