

XPression

Basic Cabling

⚠ CAUTION: Before you set up and operate this product, refer to the Important Safety and Regulatory Notices document included in the shipping box.

- 1 Attach the handles to the front rack-mount tabs by aligning the handle with the round holes and fastening from the rear with the supplied screws.

Use the supplied Rack Mount Kit to mount the XPression system in a 19" EIA equipment rack.

For information on installing the XPression chassis in a rack, see the provided document "Installing the Chassis in a Rack".

- 2 Plug an Ethernet cable from your Local Area Network into one of the **Ethernet** ports (a) 2 x 10GbE, (b) 1 x 2.5GbE, (c) 1 x 1.0 GbE.

For information on the IPMI port (d) refer to the XPression 4RU Maintenance Guide.

XPression systems can run standalone or accept a connection to a production network. The network connection is also used for the RossTalk / Smart GPI feature.

- 3 Plug the supplied keyboard into a **USB** port.

- 4 Plug the supplied mouse into a **USB** port.

- 5 Connect a Monitor (customer supplied) to any of the four display ports.

KVM extenders (customer supplied) are required when the XPression system monitor, keyboard, and mouse are located remotely from the rack room.

- 6 Connect power cords from the AC on the XPression system to the mains power.

XPression system power supplies are auto-sensing and can use either 110 VAC or 220 VAC.

Continued on other side....

| Product/Model | Power Consumption | | Conditions/Notes |
|---------------|-------------------|-------------|------------------|
| | Maximum (Peak) | | |
| | Power (W) | Voltage (V) | |
| XPression 4RU | 958 | 110 | 100% Load |

Need Help?
Technical Support:
1-833-859-0499 (North America)
+800 3540 3545 (Int'l)
1 300 007 677 (Australia)
Email: techsupport@rossvideo.com

When contacting technical support, please provide the information listed on this label.

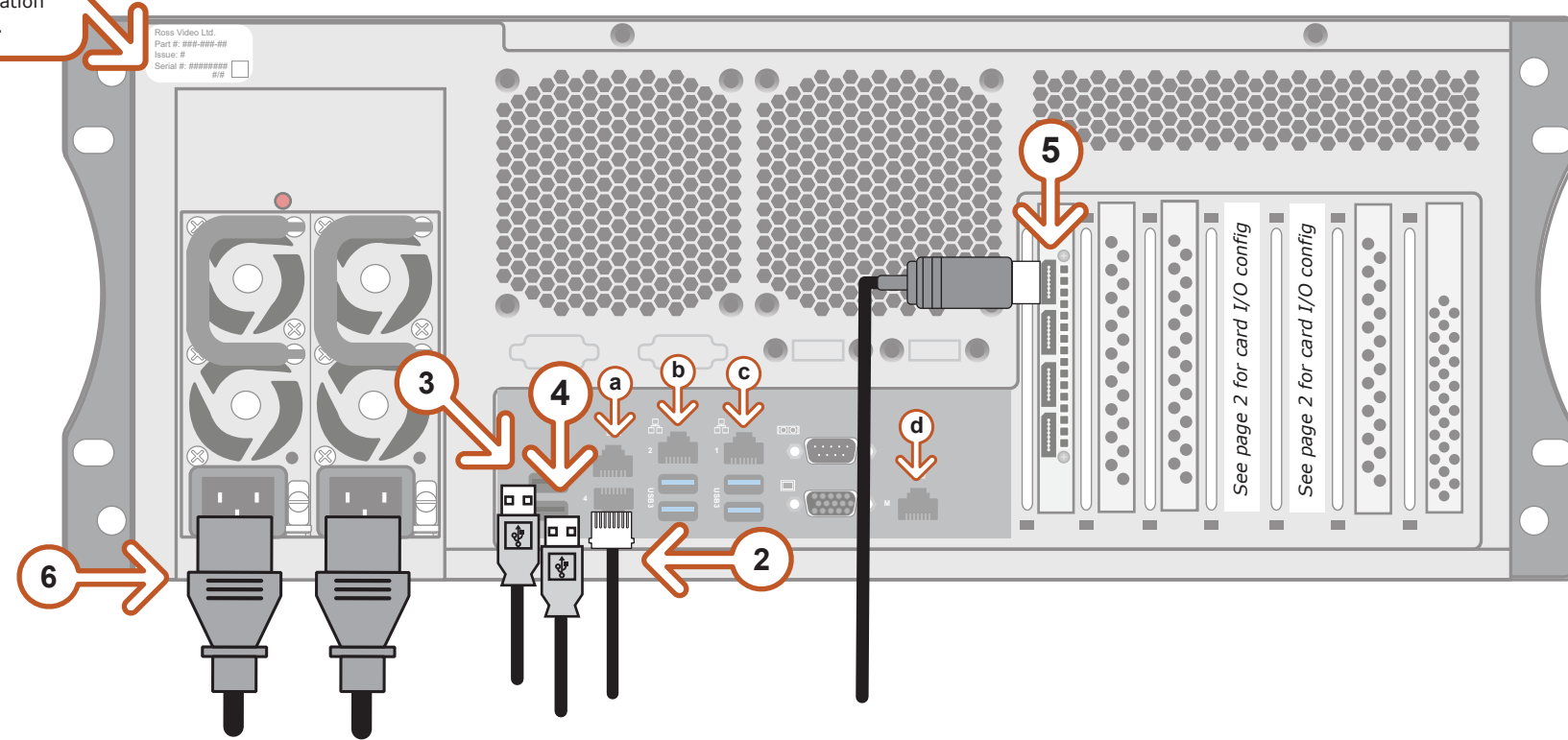
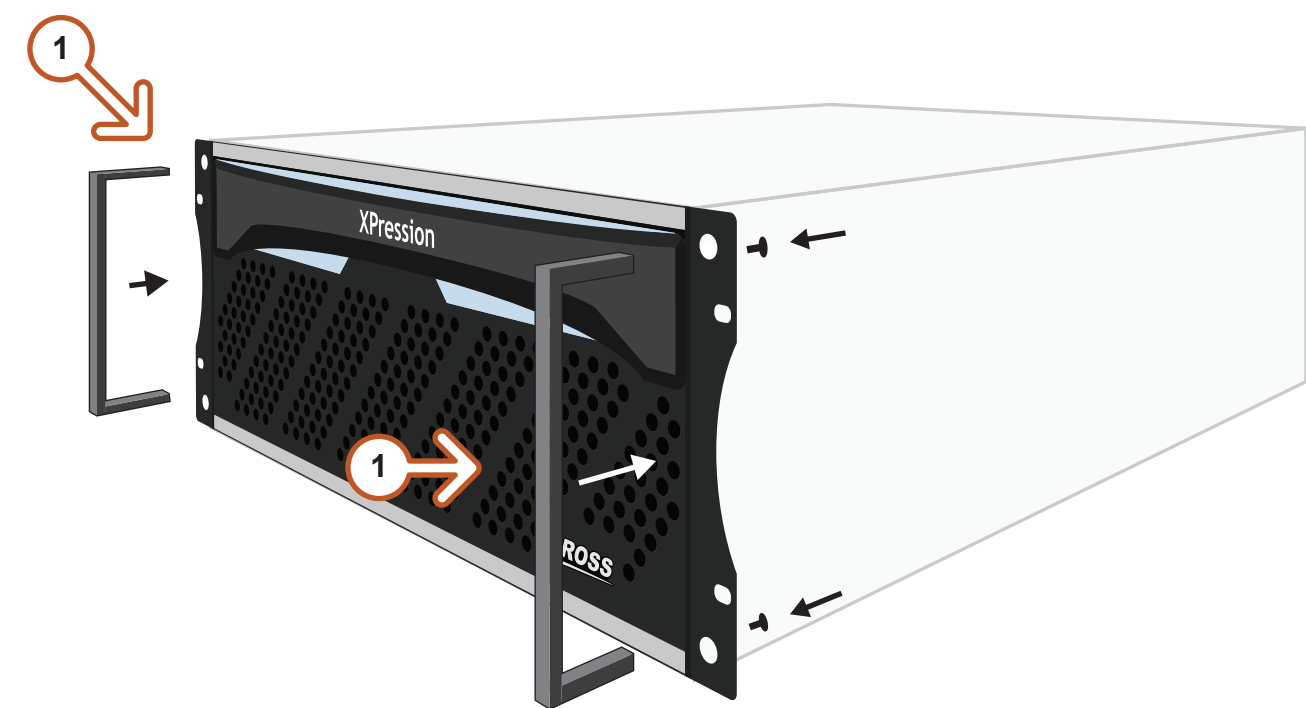

Card Cabling

To connect the IP D25 card:

- 1 Insert a small form-factor pluggable (SFP) (customer supplied) into SFP cage 1 and attach the necessary networking cable.
- 2 If using redundancy, insert a small form-factor pluggable (SFP) (customer supplied) into SFP cage 2 and attach the necessary networking cable.
- 3 Press the **Power** button (⏻) on the front of the XPression system.
Ross Video recommends shutting down XPression systems from the Windows operating system.
- 4 Click the **XPression** user account icon to log onto the system.
- 5 Launch XPression from the **Start** menu.

Windows updates: it is recommended to perform scheduled Windows updates to maintain Windows security patches. Windows updates should be scheduled during periods of downtime.

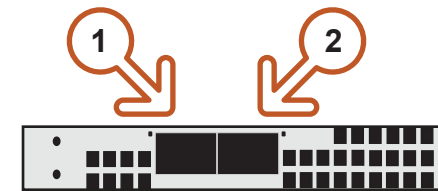

1RU and 2RU

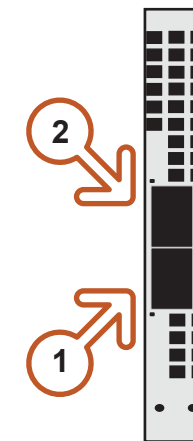

4RU

For information on...

- operating XPression, see the "XPression User Guide" available in the C:\Archive folder
- maintenance of the XPression system, see the "XPression Maintenance Guide" in the C:\Archive folder
- other XPression features and functions, see the documents available in the C:\Archive folder