

# XPression

## Basic Cabling

**⚠ CAUTION:** Before you set up and operate this product, refer to the Important Safety and Regulatory Notices document included in the shipping box.

- 1 Attach the handles to the front rack-mount tabs by aligning the handle with the round holes and fastening from the rear with the supplied screws.

Use the supplied Rack Mount Kit to mount the XPression system in a 19" EIA equipment rack.

For information on installing the XPression chassis in a rack, see the provided document "Installing the Chassis in a Rack".

- 2 Plug an Ethernet cable from your Local Area Network into one of the **Ethernet** ports (a) 2 x 10GbE, (b) 1 x 2.5GbE, (c) 1 x 1.0 GbE.

For information on the IPMI port (d) refer to the XPression 4RU Maintenance Guide.

XPression systems can run standalone or accept a connection to a production network. The network connection is also used for the RossTalk / Smart GPI feature.

- 3 Plug the supplied keyboard into a **USB** port.

- 4 Plug the supplied mouse into a **USB** port.

- 5 Connect a Monitor (customer supplied) to any of the four display ports.

KVM extenders (customer supplied) are required when the XPression system monitor, keyboard, and mouse are located remotely from the rack room.

- 6 Connect power cords from the AC on the XPression system to the mains power.

XPression system power supplies are auto-sensing and can use either 110 VAC or 220 VAC.

Continued on other side....

Product/Model	Power Consumption		Conditions/Notes
	Maximum (Peak)		
	Power (W)	Voltage (V)	
XPression 4RU	958	110	100% Load

**?** **Need Help?**  
 Technical Support:  
 1-833-859-0499 (North America)  
 +800 3540 3545 (Int'l)  
 1 300 007 677 (Australia)  
 Email: techsupport@rossvideo.com

When contacting technical support, please provide the information listed on this label.

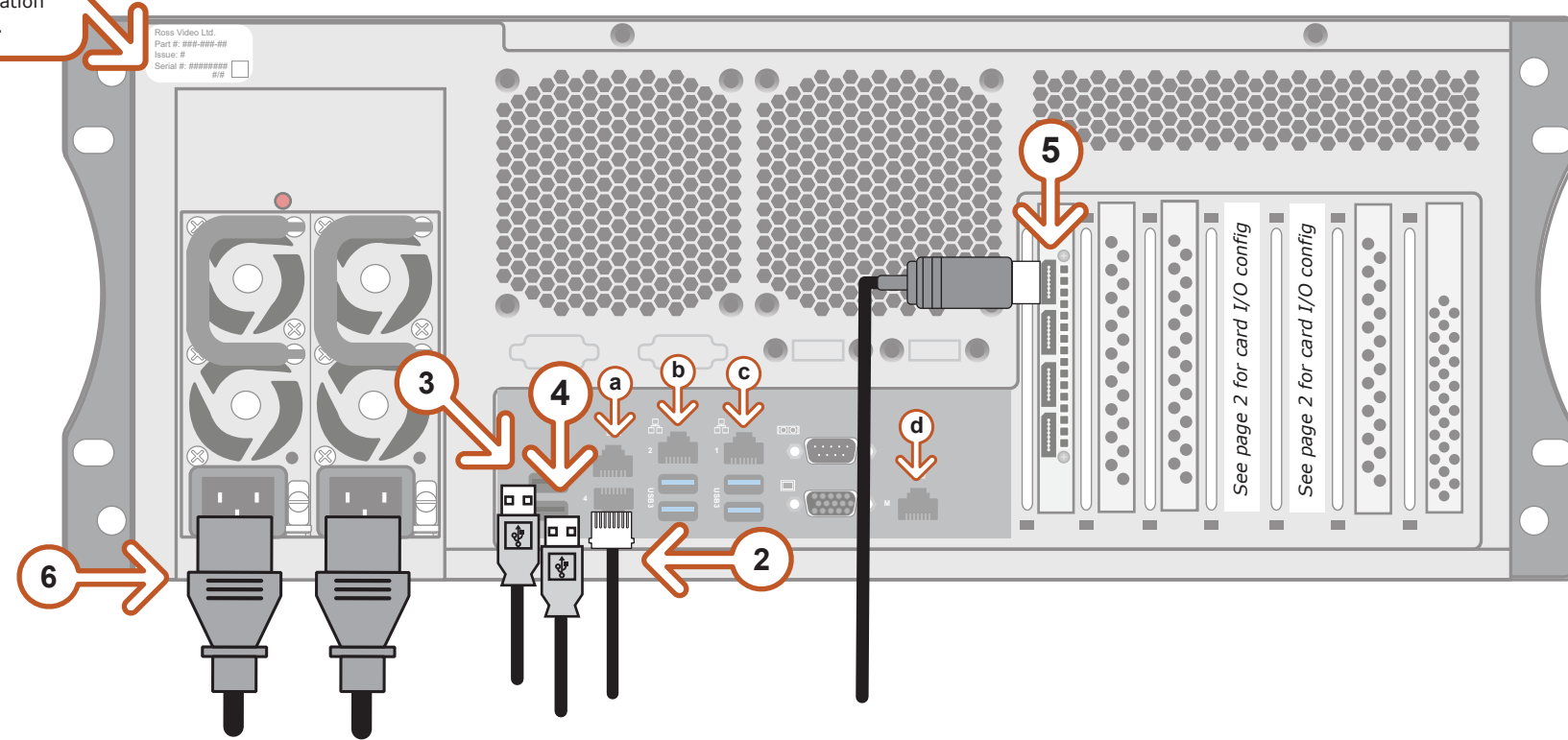
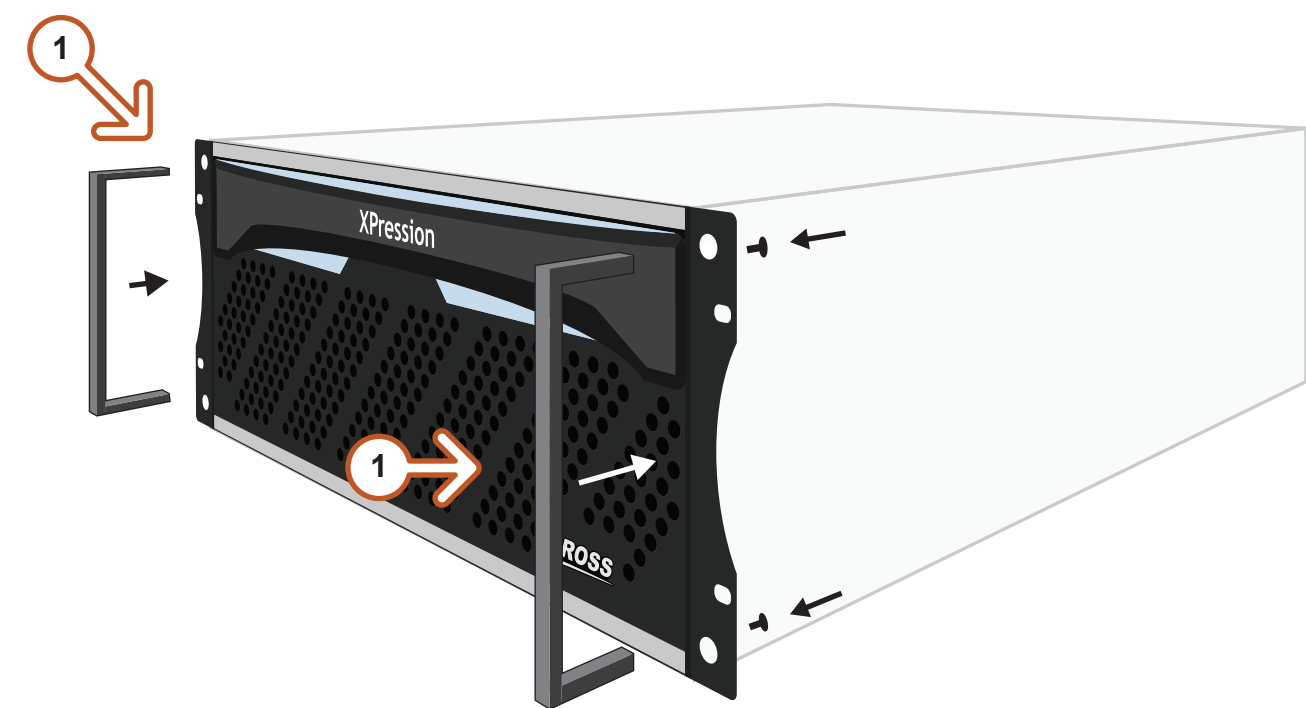

# XPression

## Card Cabling

### To connect the 12G LE5:

- 1 Connect the HD-BNC end of the pigtail cables to the HD-BNC connectors and attach the SDI cables to the BNC end of the pigtails according to their required destination (see the *XPression User Guide* or Help file for information about configuring the key and fill for the HD-BNC connectors).

See table to the right for I/O configuration.

- 2 Connect your house reference Genlock signal to the **REF** HD-BNC connector.

*XPression systems accept analog blackburst or tri-level sync as reference inputs. Tri-level sync is recommended for HD installations.*

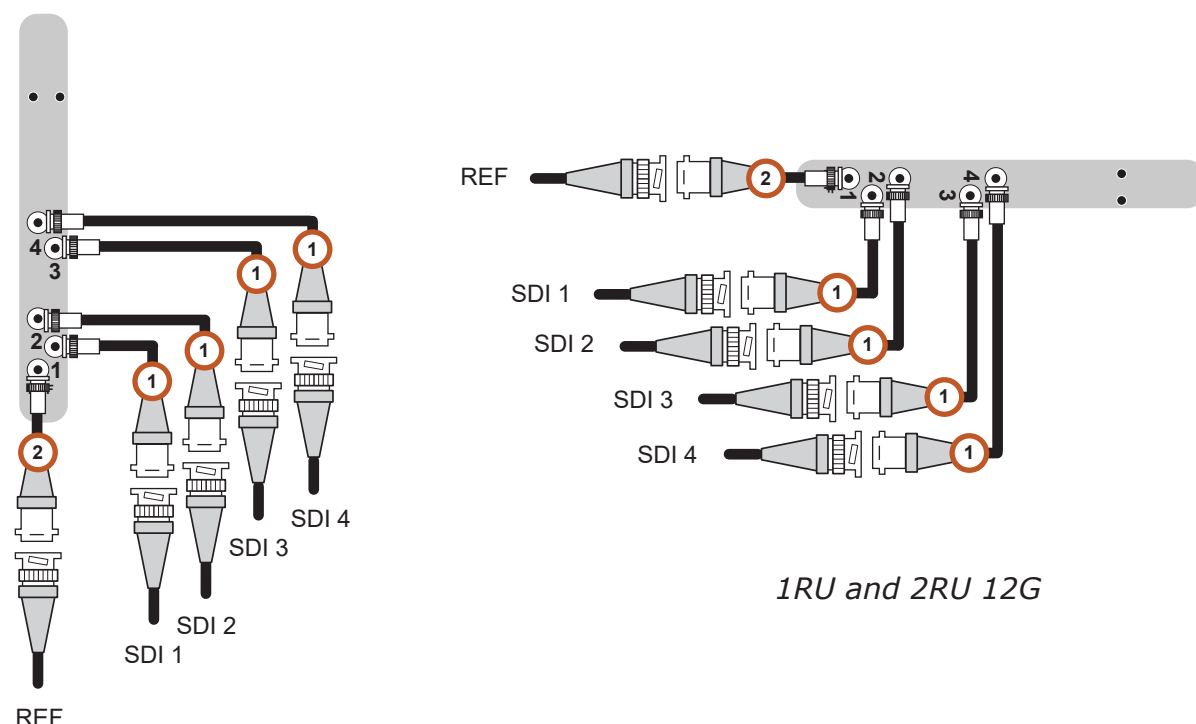

4RU 12G

1RU and 2RU 12G

HD-BNC	4 Out (Default)	1 In, 3 Out	2 In, 2 Out	4 In
1	OUT 1 (FILL)	IN 1	IN 1	IN 1
2	OUT 1 (KEY)	OUT 1 (FILL)	IN 2	IN 2
3	OUT 1 (KEY)	OUT 1 (KEY)	OUT 1 (FILL)	IN 3
4	OUT 1 (FILL)	OUT 2 (FILL)	OUT 1 (KEY)	IN 4

### To configure the 12G LE5:

- 1 Stop all applications using the Matrox card and ensure the card is installed.
- 2 In the **Command Prompt**, type the following to get to the directory:  
`cd C:\Program Files\Matrox DSX-TopologyUtils\drivers`
- 3 Then type:  
`mvConnectorConfig.exe load  
-f=Xmio5Le5ConnectorMapping\Dsxle5lp\Pinout_XiYo.pin -sn=XXXXXXX.`
- 4 Replace **Pinout\_XiYo.pin** with the **.pin** file you want to use (for example, **dsxle5lp\_4\_02i02o.pin** provides 2 inputs and 2 outputs).
- 5 Replace the **XXXXXXX** with the serial number of the Matrox card.  
To find the serial number, open the **Matrox X.info** app, select **Hardware** from the drop-down and look at the hardware information.  
The final **mvConnectorConfig** command line should like something like this:  
`mvConnectorConfig.exe load  
-f=Xmio5Le5ConnectorMapping\Dsxle5lp\dsxle5lp_4_02i02o.pin -sn=A572788`

### To launch XPression:

- 1 Press the **Power** (⏻) button on the front of the XPression system.  
*Ross Video recommends shutting down XPression systems from the Windows operating system.*
- 2 Click the XPression user account icon on the desktop.
- 3 Launch XPression from the **Start** menu.

**Windows updates:** it is recommended to perform scheduled Windows updates to maintain Windows security patches. Windows updates should be scheduled during periods of downtime.

### For information on...

- operating XPression, see the "XPression User Guide" available in the C:\Archive folder
- maintenance of the XPression system, see the "XPression Maintenance Guide" in the C:\Archive folder
- other XPression features and functions, see the documents available in the C:\Archive folder