

## Basic Cabling

**⚠ CAUTION:** Before you set up and operate this product, refer to the Important Safety and Regulatory Notices document included in the shipping box.

?

Need Help?

Technical Support:  
 1-833-859-0499 (North America)  
 +800 3540 3545 (Int'l)  
 Email: techsupport@rossvideo.com

- 1** Attach the handles to the front rack-mount tabs by aligning the handle with the round holes and fastening from the rear with the supplied screws.
- 2** Use the supplied Rack Mount Kit to mount the XPression system in a 19" EIA equipment rack.  
*For information on installing the XPression chassis in a rack, see the provided document "Installing the 1RU Chassis in a Rack".*  
*To avoid overheating, DO NOT obstruct the front air intake, rear exhaust vents, or side exhaust vent of the chassis.*

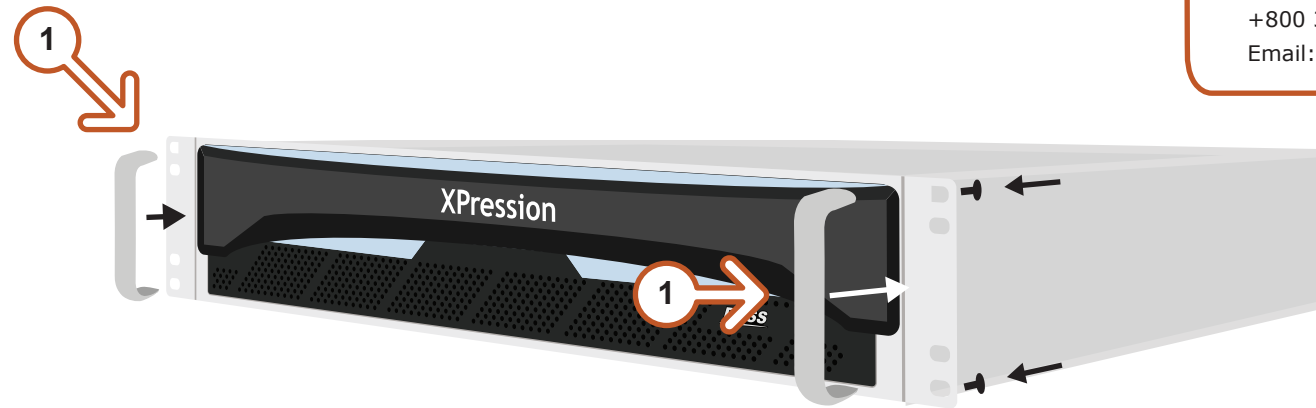

- 3** Plug the supplied keyboard into a **USB** port.
- 4** Plug the supplied mouse into a **USB** port.
- 5** Connect a monitor (customer supplied) to any of the first two display ports.  
*KVM extenders (customer supplied) are required when the XPression system monitor, keyboard, and mouse are located remotely from the rack room.*

- 6** Plug an Ethernet cable from your Local Area Network into one of the **Ethernet** ports (a) 2 x 10GbE, (b) 1 x 2.5GbE, (c) 1 x 1.0 GbE.  
*For information on the IPMI port (d) refer to the "XPression 2RU Maintenance Guide".*

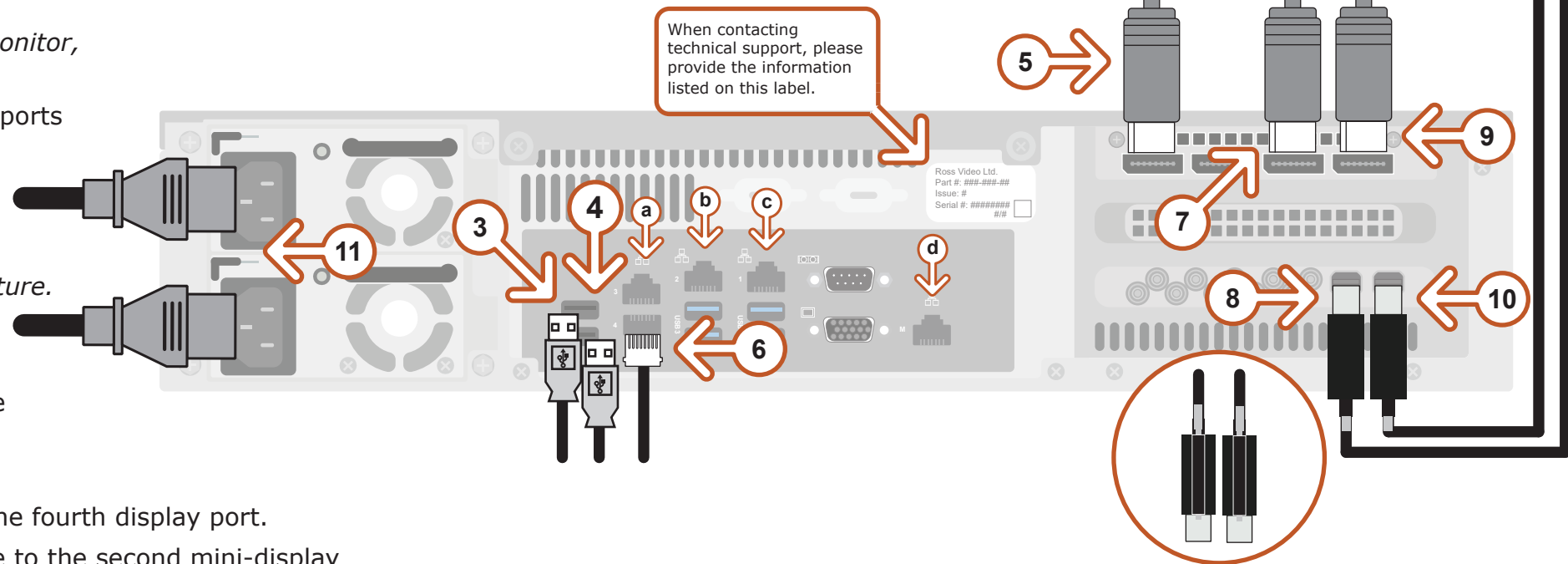

- XPression systems can run standalone or accept a connection to a production network. The network connection is also used for the RossTalk / Smart GPI feature.*
- 7** Connect the display port end of the display-port-to-mini-display-port-cable to the third display port.
- 8** Connect the mini-display port end of the display-port-to-mini-display-port-cable to the first mini-display port and fasten the screw.  
*Do not overtighten the screw.*
- 9** Connect the display port end of the display-port-to-mini-display-port-cable to the fourth display port.
- 10** Connect the mini-display port end of the display-port-to-mini-display-port-cable to the second mini-display port and fasten the screw.  
*Do not overtighten the screw.*

- 11** Connect power cords from the AC ports on the XPression system to the mains power.  
*XPression system power supplies are auto-sensing and can use either 110 VAC or 220 VAC.*

*Continued on other side...*

Product/Model	Power Consumption		Conditions/Notes
	Maximum (Peak)		
	Power (W)	Voltage (V)	
Ross I/O 2RU	512	110	100% Load

## Card Cabling

- 1 Connect your house reference Genlock signal to the **REF** HD-BNC connector.  
*XPression systems accept analog blackburst or tri-level sync as reference inputs. Tri-level sync is recommended for HD installations.*
- 2 Connect the HD-BNC end of the pigtail cables to the HD-BNC connectors and attach the SDI cables to the BNC end of the pigtails according to their required destination (see the *XPression User Guide* or Help file for information about configuring the key and fill for the HD-BNC connectors). The default and UHD configuration is displayed in the tables below.  
*Not all HD-BNC connectors will be active depending on the XPression software edition. Keep any unused pigtail and SDI cables in a safe place for future use. If your facility requires analog outputs, additional outboard digital to analog conversion equipment is available from Ross Video.*  
*Inputs/outputs can be configured in the Hardware Setup. See the XPression User Guide or Help file for instructions.*
- 3 Press the **Power** button (⏻) on the front of the XPression system.  
*Ross Video recommends shutting down XPression systems from the Windows® operating system.*
- 4 Select the **XPression** user account icon to log onto the system.
- 5 Launch XPression from the **Start** menu.

**Windows updates:** it is recommended to perform scheduled Windows updates to maintain Windows security patches. Windows updates should be scheduled during periods of downtime.

### Software Bypass

I1 ==> O1  
I2 ==> O2  
I3 ==> O3  
I4 ==> O4

Note: Available when system is running

### Sample configurations:

I/O	2 In 3 Fill/Key*	8 Out	4 Fill/Key	4 In 4 Out	1 Fill 2 Fill/Key	2 Fill 2 Fill/Key
I1/O8	In 1	Out 8	Out 4 Key	In 1	--	--
I2/O7	In 2	Out 7	Out 4 Fill	In 2	--	--
I3/O6	Out 3 Key	Out 6	Out 3 Key	In 3	Out 3 Key	Out 4 Key
I4/O5	Out 3 Fill	Out 5	Out 3 Fill	In 4	Out 3 Fill	Out 4 Fill
O4	Out 2 Key	Out 4	Out 2 Key	Out 4	Out 2 Key	Out 3 Key
O3	Out 2 Fill	Out 3	Out 2 Fill	Out 3	Out 2 Fill	Out 3 Fill
O2	Out 1 Key	Out 2	Out 1 Key	Out 2	--	Out 2
O1	Out 1 Fill	Out 1	Out 1 Fill	Out 1	Out 1	Out 1

\*Default setup

I/O	SD/HD	UHD
I1/O8	Out 8/Out 4 Key/In 1	In 1
I2/O7	Out 7/Out 4 Fill/In 2	In 2
I3/O6	Out 6/Out 3 Key/ In 3	--
I4/O5	Out 5/Out 3 Fill/In 4	--
O4	Out 4/Out 2 Key	Out 4/Out 2 Key
O3	Out 3/Out 2 Fill	Out 3/Out 2 Fill
O2	Out 2/Out 1 Key	Out 2/Out 1 Key
O1	Out 1/Out 1 Fill	Out 1/Out 1 Fill

Note: Key is always on an even output

### For information on...

- operating XPression, see the "XPression User Guide" available in the C:\Archive folder
- maintenance of the XPression system, see the "XPression Maintenance Guide" in the C:\Archive folder
- other XPression features and functions, see the documents available in the C:\Archive folder

